



ASPIRE

— TO MOVE —



Phoenix House, Bath, BA1

Video and physical viewings available. An unfurnished one bedroom apartment located 0.1 miles from the Royal Victoria Park. Available now.

Phoenix House is a purpose built block of apartments located on the north side of Bath city centre. There are a number of bars, restaurants and cafes all on your doorstep and Royal Victoria Park is just 0.2 miles away.

£1,050 PCM

Phoenix House, Bath, BA1

- Video viewing available
- White goods included
- Available now
- Holding deposit: £242
- One bedroom apartment
- Close to the city centre
- Council tax band A
- Unfurnished
- Shops on Julian Road
- 12 month contract

Video and physical viewings available. An unfurnished one bedroom apartment located 0.1 miles from the Royal Victoria Park. Available now.

Phoenix House is a purpose built block of apartments located on the north side of Bath city centre. There are a number of bars, restaurants and cafes all on your doorstep and Royal Victoria Park is just 0.2 miles away.

The apartment is on the top floor and is access via a communal stairwell. The kitchen has base units, oven, hob, fridge, freezer, dishwasher and washer/dryer. The living room has dual aspect, access to the balcony and a storage cupboard. The bedroom is a good size and has a built in wardrobe. The bathroom has shower over bath, WC, sink and storage cupboard. The building has a communal garden and bin store.

The flat is offered unfurnished and is available now. The flat would suit a single professional or couple.

Council tax band A: £1404.70





TOP FLOOR
458 sq.ft. (42.5 sq.m.) approx.

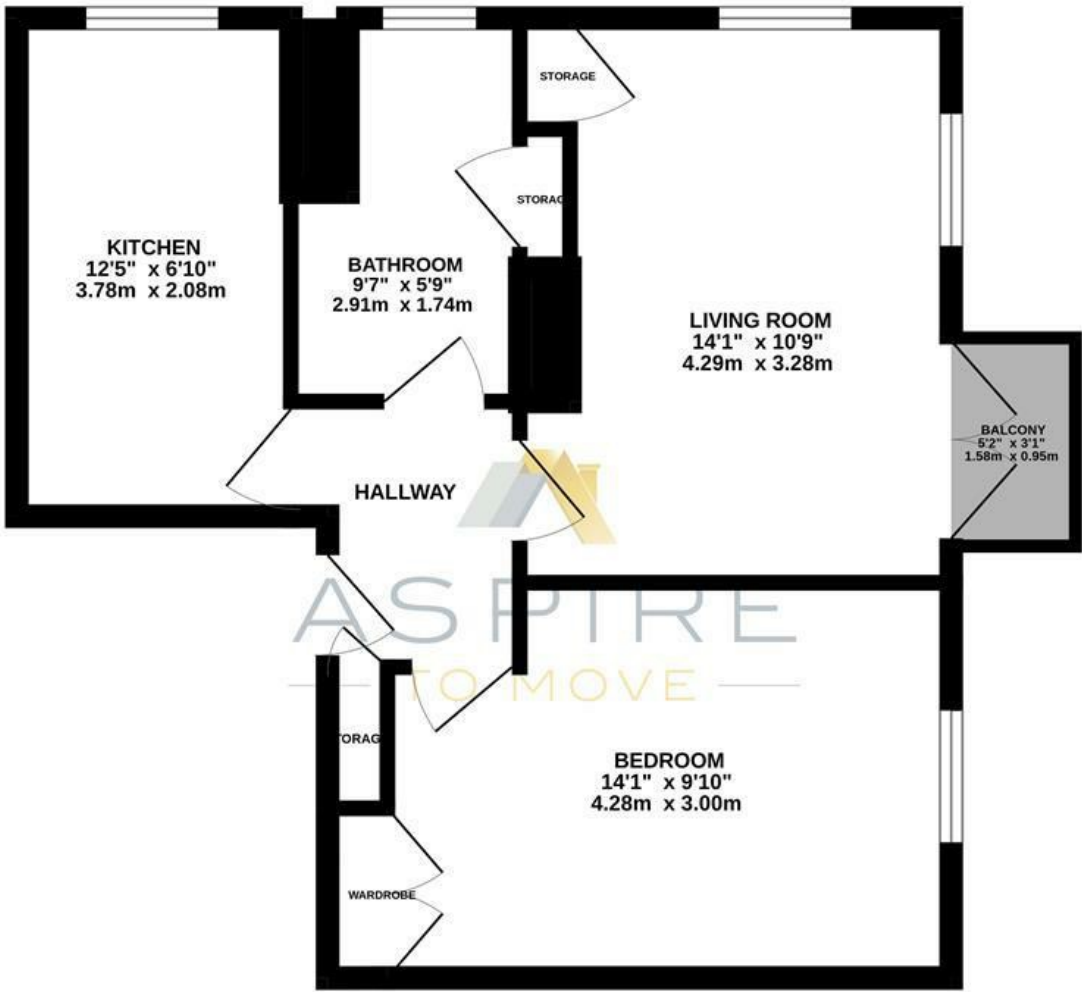

PHOENIX HOUSE, BATH, BA1

TOTAL FLOOR AREA : 458 sq.ft. (42.5 sq.m.) approx.

Whilst every attempt has been made to ensure the accuracy of the floorplan contained here, measurements of doors, windows, rooms and any other items are approximate and no responsibility is taken for any error, omission or mis-statement. This plan is for illustrative purposes only and should be used as such by any prospective purchaser. The services, systems and appliances shown have not been tested and no guarantee as to their operability or efficiency can be given.

Made with Metropix ©2024

These particulars, whilst believed to be accurate are set out as a general outline only for guidance and do not constitute any part of an offer or contract. Intending purchasers should not rely on them as statements of representation of fact, but must satisfy themselves by inspection or otherwise as to their accuracy. No person in this firms employment has the authority to make or give any representation or warranty in respect of the property.

